

STUFFALOONS™

WELCOME TO THE WORLD OF STUFFED BALLOONS

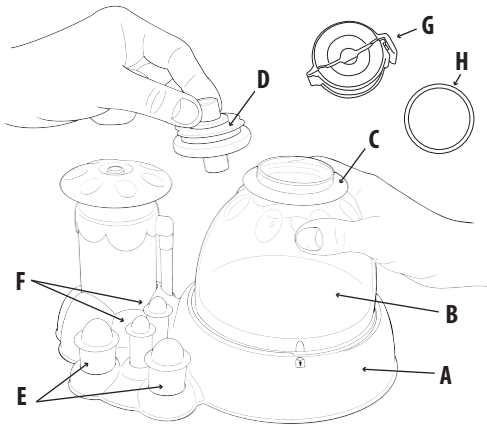

Stuffaloons Maker Components:

- A - Base
- B - Dome
- C - Blue Ring
- D - Pink Stopper
- E - 2 Big Bottles
- F - 2 Small Bottles
- G - Clip
- H - O-Ring

Read and follow all instructions before using the Stuffaloons maker kit.

Adult supervision required for children under 8 years.

Check out our website for lots of fun tips!
www.stuffaloons.com

PLEASE REMOVE ALL PACKAGING BEFORE GIVING PRODUCT TO A CHILD. PLEASE RETAIN PACKAGING DETAILS FOR FUTURE REFERENCE.

Stuffaloons Maker Kit is only to be used with Stuffaloons balloons. Refills sold separately.

⚠ WARNING! CHOKING HAZARD. Small parts. Not suitable for children under 3 years. Children under 8 years can choke or suffocate on uninflated or broken balloons. Adult supervision required. Keep uninflated balloons from children. Discard broken balloons at once. Balloons are made of natural rubber latex. Do not use close to ears or head. Misuse may cause damage to hearing or eyes.

⚠ WARNING! STRANGULATION HAZARD. Long cord. Risk of entanglement. Keep away from head and neck.



Made in China.

COMPLIES WITH THE SAFETY REQUIREMENTS OF ASTM F963 AND EN71. Contents may vary in color, style, decoration and shape from images shown on packaging or in advertising.

WARNING: BALLOONS ARE NOT TO BE INFLATED BY MOUTH, INFLATE WITH THE BALLOON PUMP ONLY! SMALL PARTS MAY BE INHALED!

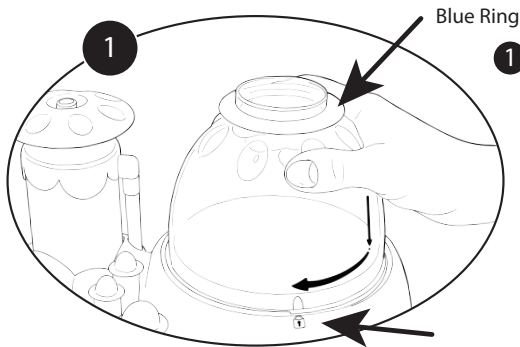

- 1** Place the Clear dome onto the Maker Station and twist clockwise until it locks tightly closed. Locks must align with dome and maker station.

- 2** Place blue ring on top of dome. Carefully wrap the balloon opening around the top of the dome.

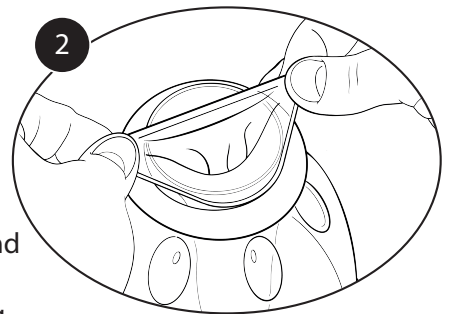

TIP - Use a damp cloth to gently wipe your inflated clear balloon. Then gently wipe it dry with a soft dry cloth. This will improve the clearness of your balloon.

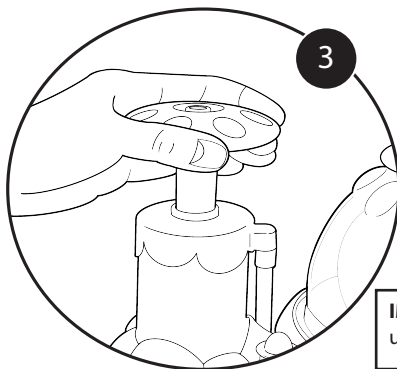

- 3** Pump the air pump handle and the balloon will 'inflate' within the clear dome. Keep pumping until the balloon fills the chamber. If the balloon doesn't inflate, please repeat step 1 to ensure dome and maker kit are locked.

IMPORTANT - Only Stuffaloons balloons are to be used with Stuffaloons Maker Kit.

TIP - If this is your first time try a practice balloon first with NO stuffing inside and go to step 6. Once you've mastered the process come back and try again adding your stuffing.

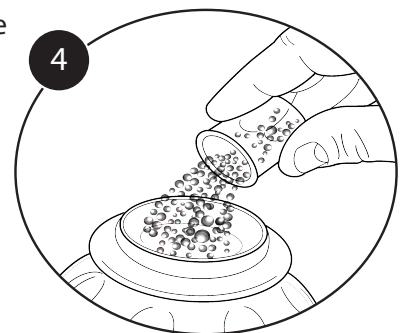

- 4** Once balloon is inflated in the chamber, you may now choose your Stuffaloons Deco to make your own creation. **DO NOT** use sharp objects, this will cause the balloon to burst. You can choose stuffing items that come with Maker Kit or get creative and choose your own stuffing.

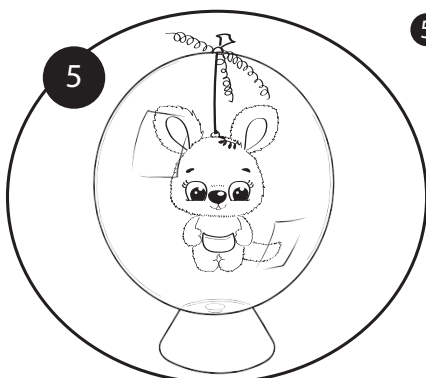

- 5** Adding Small Plush (Recommend using Stuffaloons Plush): A small plush may be added to the bottom of balloon or hanging from the top of the balloon.
- Option 1 - Adding Plush on Bottom: Simply place plush into the opening of Balloon to allow the plush to move freely.
- Option 2 - Hanging Plush from top of Balloon: Stuffaloons Plush includes a loop to attach curly ribbon. Once ribbon is tied to plush, place plush inside the balloon leaving a portion of the ribbon to hang out of the opening of the top of the balloon. After all deco is inside the balloon pull the ribbon for placement of plush.

TIP - This technique can also be used for hanging other types of items within the balloon.

- 6 Place the larger side of the pink stopper gently into the opening of the balloon that is sitting in the dome to seal in all air. Be careful not to let the stopper fall inside.

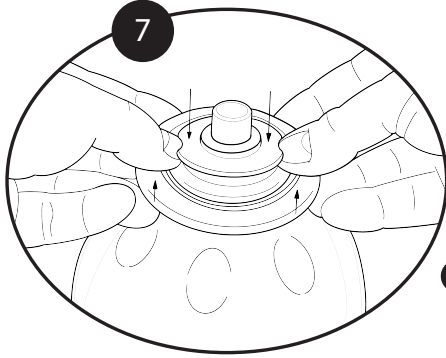
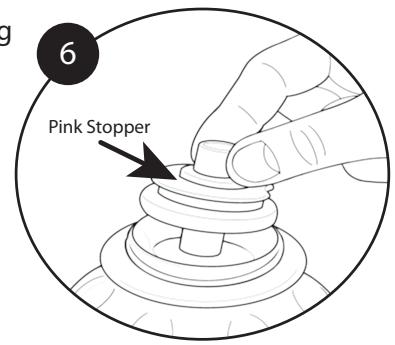

- 7 Check to make sure the balloon opening is securely fitted around the pink stopper. Then firmly lift the blue ring up and over the stopper. No air should escape.

- 8 Twist the clear dome counter-clockwise to unlock and remove the dome. Gently remove the Stuffaloons balloon.

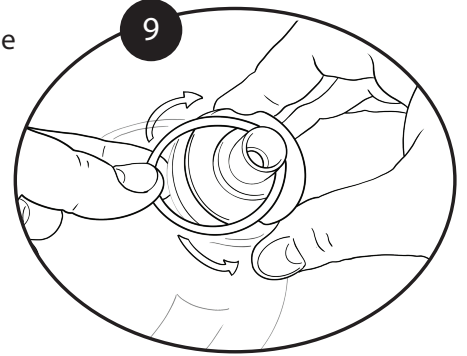

- 9 Before inflating the balloon with the pump attach the rubber o-ring to the neck of the balloon. Stretch the o-ring over the stopper so it fits around the neck of the balloon.

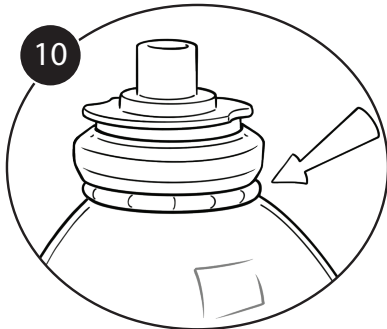

- 10 See arrow for ring position. Now you can inflate the balloon. The rubber ring will be removed after the final stage of fixing the clip to seal the balloon.

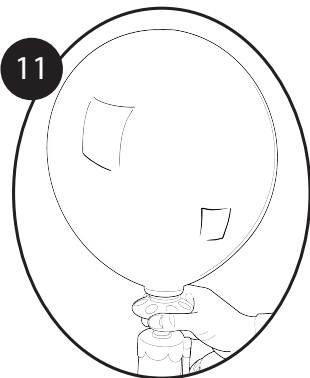
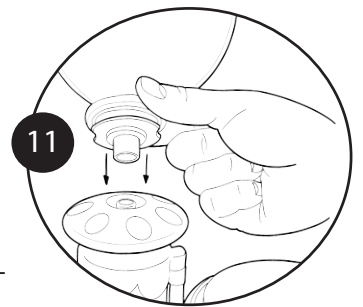

- 11 After removal of stuffed balloon, place the pink stopper side securely onto the pump handle for inflation. **WARNING** – Over inflating the balloon could cause it to burst! While inflating the balloon check balloon elasticity to make sure you have not overinflated the balloon.

- 12 Now you're ready to seal your balloon. Pull the stopper gently away from the balloon to stretch the opening and gently twist the stopper.

DO NOT PULL THE STOPPER OUT!

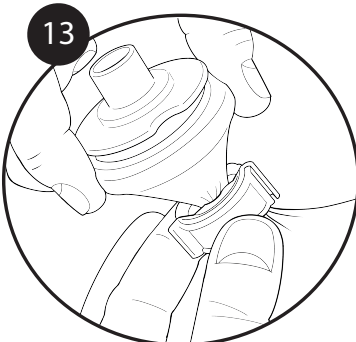
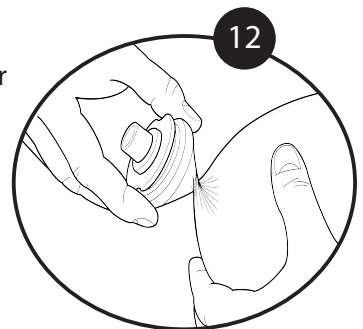

- 13 Place the clip around the twisted opening of the balloon and snap it closed. Clips can be used multiple times.

Tip: Option to seal balloon with ribbon or string.

- 14 Remove rubber o-ring and pink stopper once balloon is sealed.

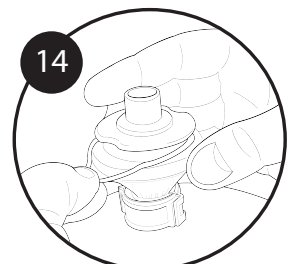

Manufactured by ©2020 BOTI Global Ltd., Unit 404A-5,
4/F/ Tower I, South Seas Centre 75 Mody Road, TST,
Kowloon, Hong Kong. www.bot-i.com.
questions@bot-i.com.

@bigontoyinnovation

Jay@Play®

Distributed by Jay at Play Int'l HK Ltd.

817 Houston Centre, 63 Mody Road, TST East Kowloon, Hong Kong.